

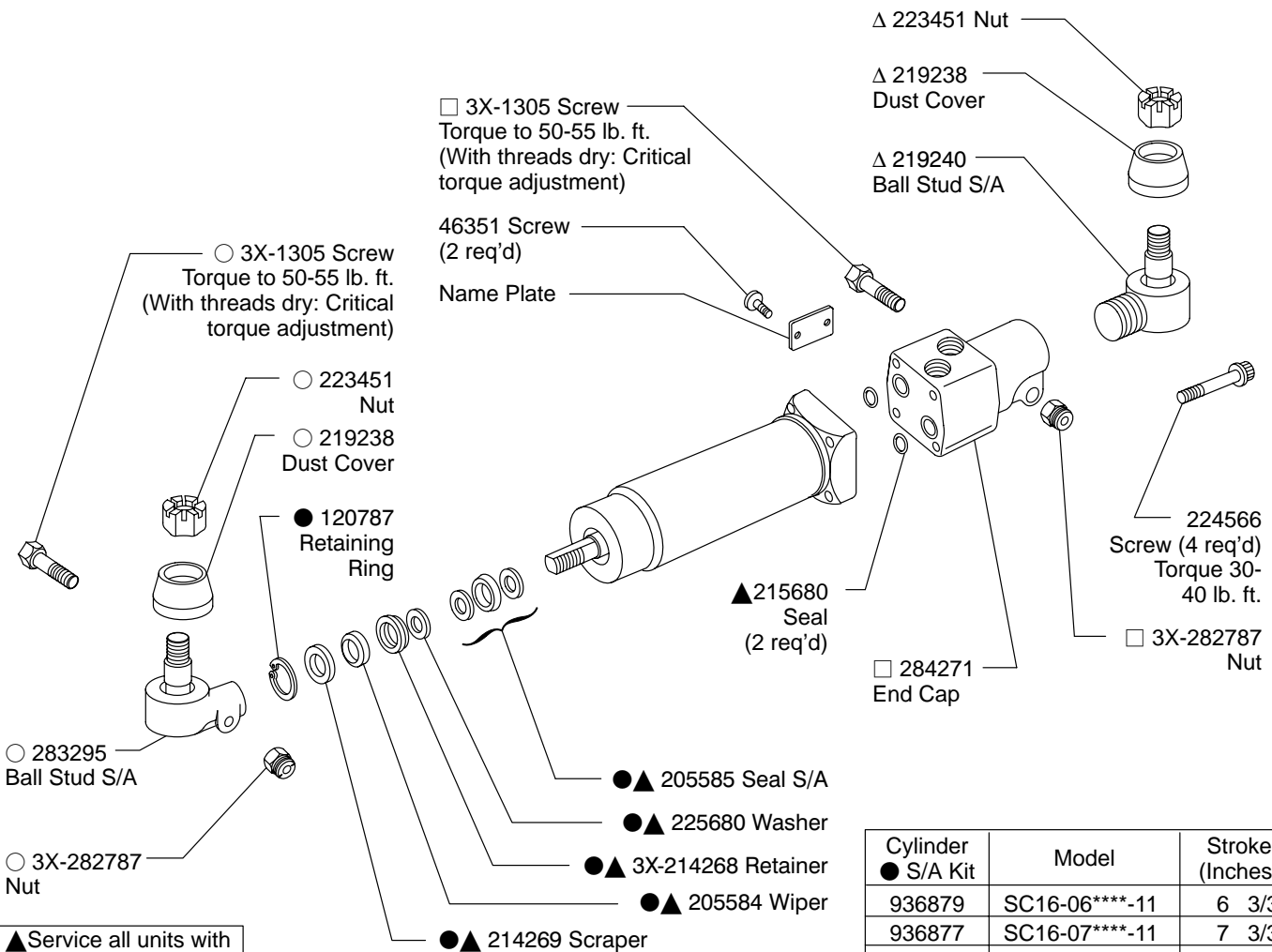

## Steering Cylinder SC16-\*\*\*\*\*-11

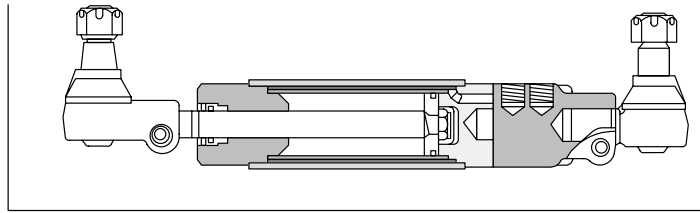

Cylinder ● S/A Kit	Model	Stroke (Inches)
936879	SC16-06****-11	6 3/32
936877	SC16-07****-11	7 3/32
936919	SC16-08****-11	8 3/32
936920	SC16-09****-11	9 3/32
936875	SC16-10****-11	10 3/32
936873	SC16-11****-11	11 3/32
936921	SC16-12****-11	12 3/32
936922	SC16-13****-11	13 3/32
936923	SC16-14****-11	14 3/32
936924	SC16-15****-11	15 3/32
936925	SC16-16****-11	16 3/32

# Model Code

**SC 16 - \*\* \* \* \* \* - 11**

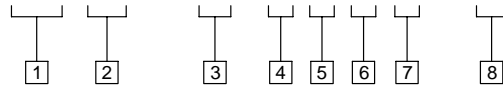

**1 Steering Cylinder**

**2 Cylinder Bore Diameter**

(1/8 inch increments)  
**16** - 2 inch diameter

**3 Stroke**  
(Inches)

- 06** - 6 3/32 inch
- 07** - 7 3/32 inch
- 08** - 8 3/32 inch
- 09** - 9 3/32 inch
- 10** - 10 3/32 inch
- 11** - 11 3/32 inch
- 12** - 12 3/32 inch
- 14** - 14 3/32 inch
- 15** - 15 3/32 inch
- 16** - 16 3/32 inch

**4 Rod End Mounting**

- N** - No attachment
- B** - Horizontal ball stud - Nylon seat

**5 End Cap**

- N** - No end cap
- 1** - 20 USgpm  
1.125-12 UNF female thread

**6 Head End Mounting**

- N** - No attachments
- B** - Horizontal ball stud - Nylon seat

**7 Head End Mounting Position**

- N** - No position or attachment
- W** - Opposite port connections
- X** - 90° counterclockwise from port connections
- Y** - In line with port connections
- Z** - 90° clockwise from port connections

**8 Design**

For satisfactory service life of these components, use full flow filtration to provide fluid which meets ISO cleanliness code 20/18/15 or cleaner. Selections from Eaton OFP, OFR and OFRS filter series are recommended.

Printed in U.S.A.