

Service Data

Vickers®

Relief Valves



Multi-Pressure Relief Valves

CG-(H)-06-*(V)-(P)(*)DG(L)-8C-(H)-(*)-20

CG-(H)-10-*(V)-(P)(*)DG(L)-8C-(H)-(*)-20



Model	Head #1		Head #2		Head #3		●CG-(H)06 Cover S/A
	● Spring	Pressure Range PSI	● Spring	Pressure Range PSI	● Spring	Pressure Range PSI	
CG-(H)06/(H)10-CBF	583937	500 - 2000	2280	125 - 1000	2281	1500 - 3000	942198
CG-(H)06/(H)10-CEB			VENT	125 - 1000	2280	125 - 1000	—
CG-(H)06/(H)10-CBC			2280	—	583937	500 - 2000	942202
CG-(H)06/(H)10-FFB	2281	1500 - 3000	2281	1500 - 3000	2280	125 - 1000	942326

● Included in cover assembly

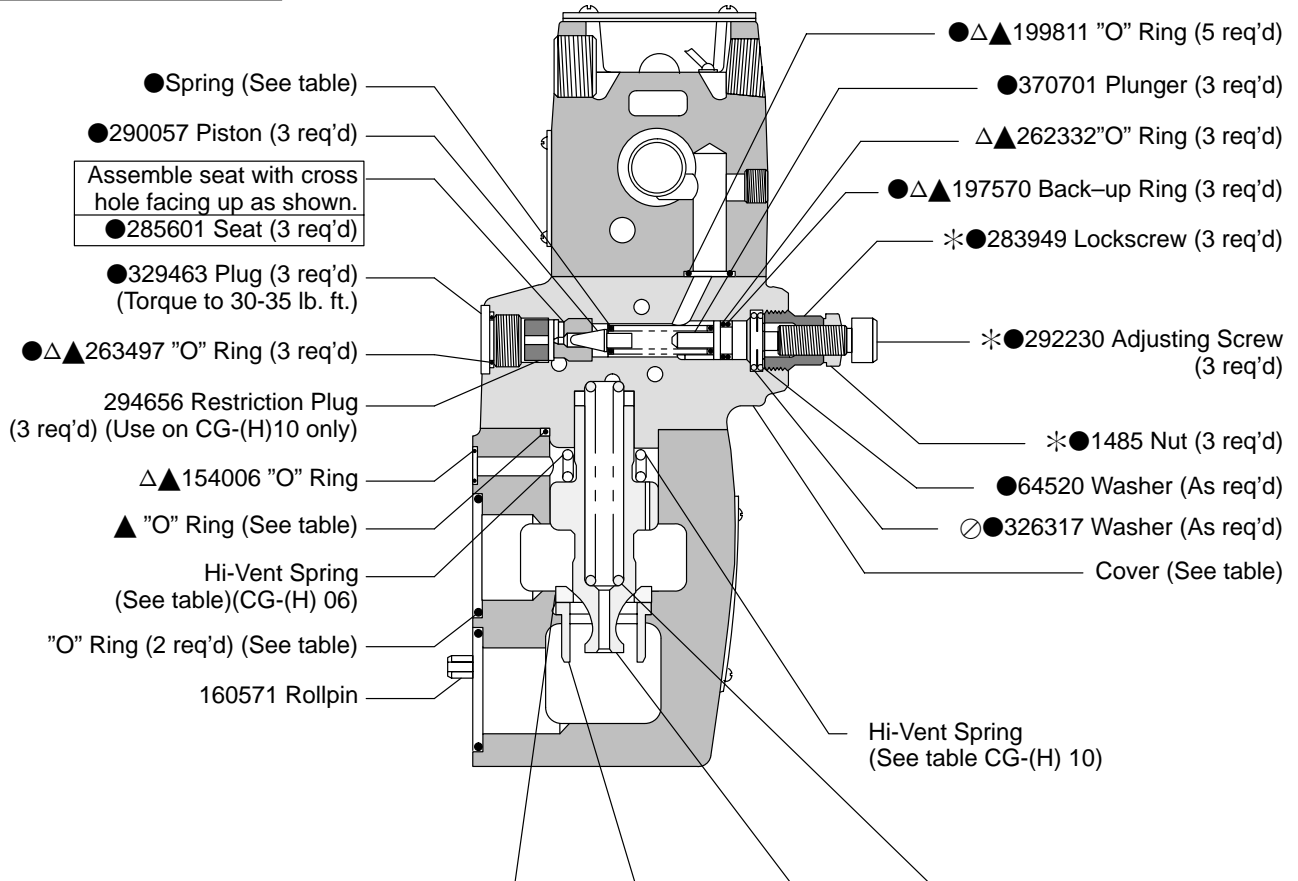

Model	"O" Ring	"O" Ring (2 req'd)	Body	Seat	Sleeve	Hydro Cone	Lo-Vent Spring	Hi-Vent Spring	● Cover
CG-06	●▲ 262361	▲ 154020	580456	343153	—	343154	2077	184458	370664
CG-H06				589473	589472				
CG-10	●▲ 262367	▲ 154024	581703	283954	—	283952	291822	291821	370669
CG-H10				587996	400730				

○ This part used at final test to obtain correct pressure range.

Use either a Lo-Vent or Hi-Vent spring as shown. Do not use both.

***Note**
Coat 292330 Adjusting Screw, 283949 Lockscrew, and 1485 Locknut with oil prior to assembly.

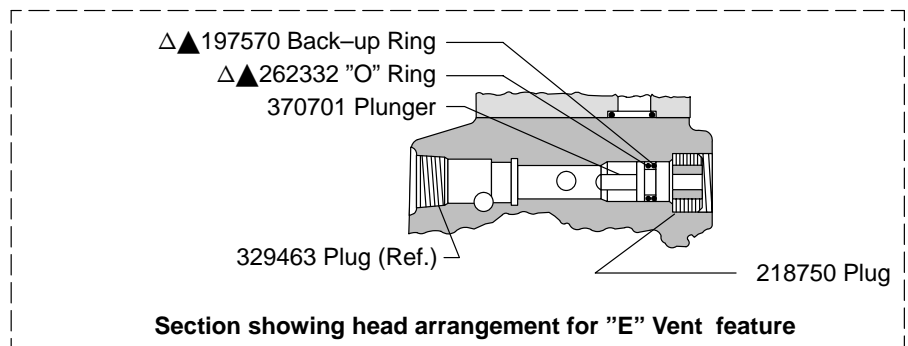

Insta-plug connectors for DG4S4 Pilot Stage are shown on drawing I-3487-S.

Oil immersed solenoid information is shown on drawing I-3498-S.



WARNING

Do not use other than a DG4S4-018C-*50 directional valve as the pilot for this relief valve. Use of a different pilot can block the relief valve causing excessive system pressure.

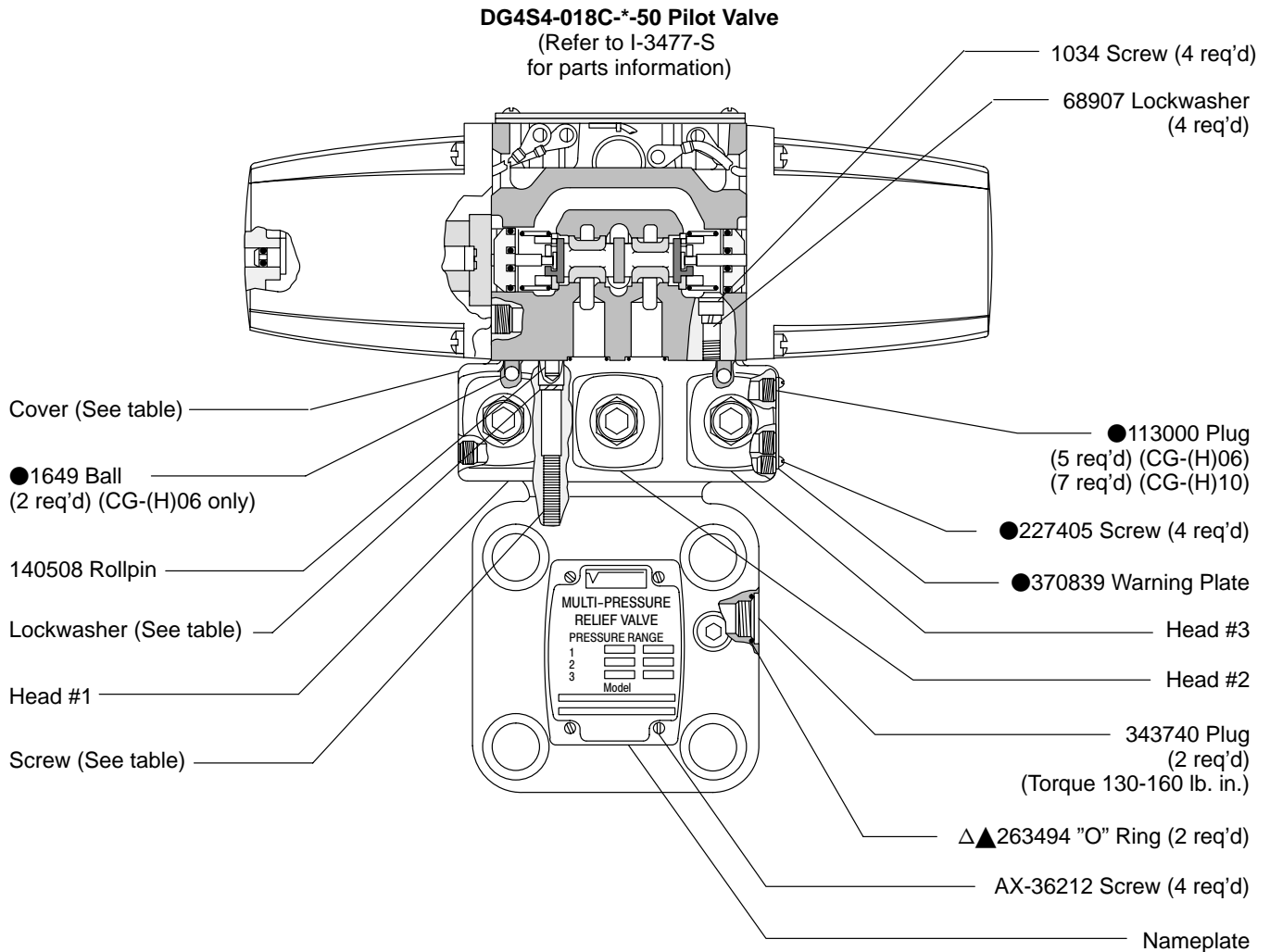

▲ Included in (F3)CG-(H)06 Seal Kit 919684

△ Included in (F3)CG-(H)10 Seal Kit 919685

All seals, except directional valve & relief valve interface seals, are F3. Use F3 seal kit to service all units.

Model Code

(F3) - CG - (H) ** - * (V) - (P) (*) DG(L) - 8 C - (H) - (*) - 20

┌───┐
┌───┐
┌───┐
┌───┐
┌───┐
┌───┐
┌───┐
┌───┐
┌───┐
┌───┐
┌───┐
┌───┐
┌───┐
┌───┐
┌───┐
┌───┐

1
2
3
4
5
6
7
8
9
10
11
12
13
14
15
16

1 Seal Material

F3 - Seals for mineral oil and fire resistant fluids

2 Model Series

CG - Relief valve, manifold or subplate mounted

3 Flow

H - High flow

4 Nominal Size

06 - 3/4"
10 - 1 1/4"

5 Pressure Range PSI
(For head #1, #2 & #3)

B - 125 - 1000 PSI
C - 500 - 2000 PSI
F - 1500 - 3000 PSI
E - Vent

6 Vent Spring

V - High vent spring
Omit - Low vent spring

7 Insta Plug

(Omit when not required)
P - Insta Plug feature

8 Plug

(Omit when not required)
A - With plug only
B - With plug and receptacle

9 Pilot Stage

D - Directional valve

10 Mounting

G - Manifold or subplate mounted

11 Solenoid Indicator Light

L - Solenoid indicator lights
Omit - Without lights

12 Spool Type

8 - Tandem open center crossover spool

13 Pilot Valve Type

C - Spring centered

14 Solenoid

H - Oil immersed solenoid
Omit - Standard solenoid

15 Solenoid Voltage

Omit - Standard voltage 115AC 60

16 Design

For satisfactory service life of these components in industrial applications, use full flow filtration to provide fluid which meets ISO cleanliness code 18/15 or cleaner. Selections from Eaton OFF, OFR, and OFRS series are recommended.