

Flow Control Valves

FRG-03-\*-28-2\*

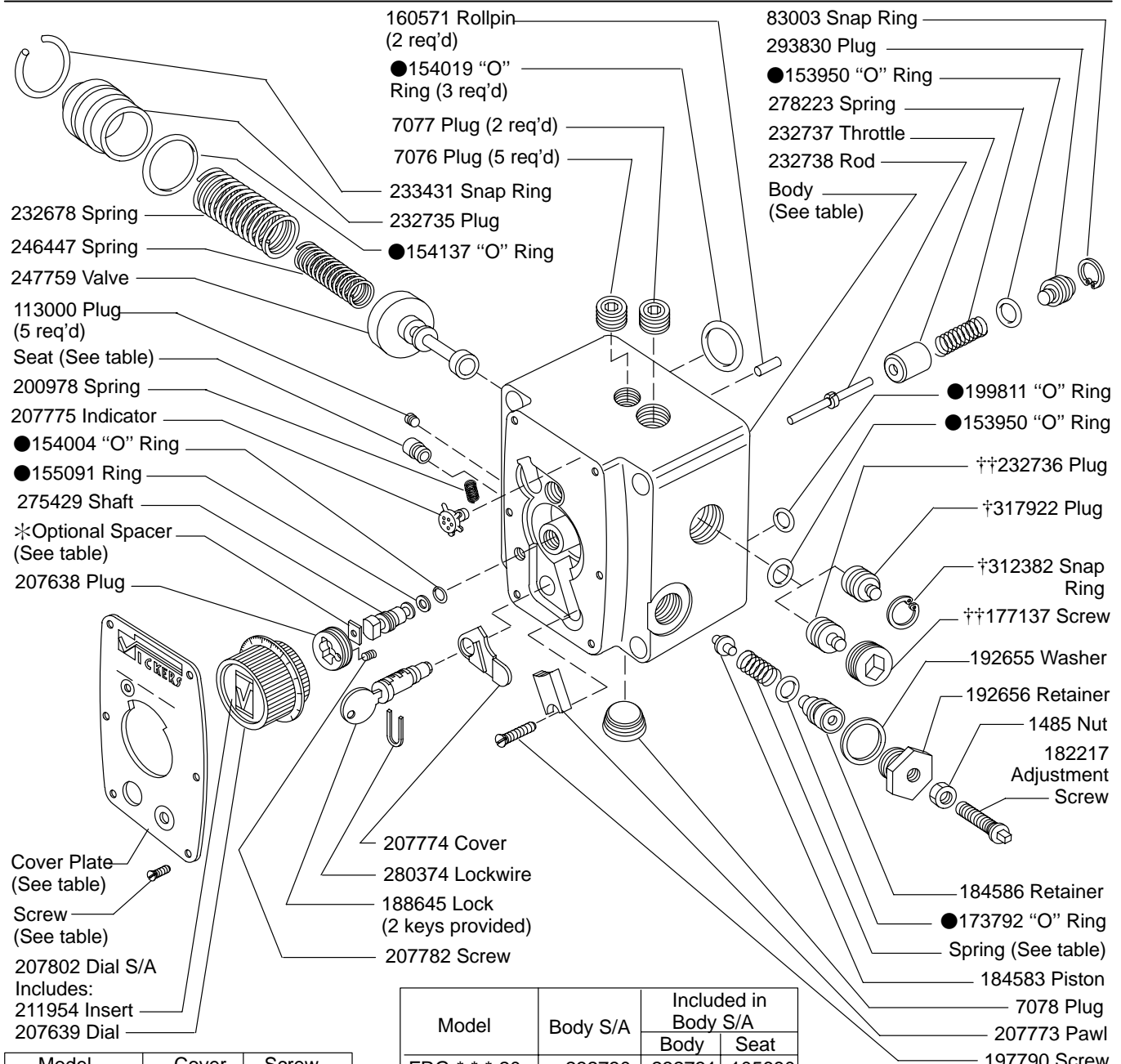

Model	Cover Plate	Screw (6 req'd)
FRG-*-**-20	232739	184173
FRG-*-**-22	315976	3X-117655

Model	Body S/A	Included in Body S/A	
		Body	Seat
FRG-*-**-20	232730	232731	105680
FRG-*-**-22	330936	330938	105680

Model	Pressure Adj. to PSI max.	Spring
FRG-*-B-*-20/22	1000	175071
FRG-*-C-*-20/22	2000	175072
FRG-*-F-*-20/22	3000	175073

Optional spacers (211026) are available to limit the maximum throttle opening as follows:

Number of Spacers	Limit of Maximum Volume USgpm
3	4.5 to 6
2	10 to 13
1	18 to 21

- † Used on -22 Design only
- †† Used on -20 Design only
- F3 equivalent 919398 Seal Kit
- Included in 919213 Seal Kit

**FRG-03-\*-28-21**

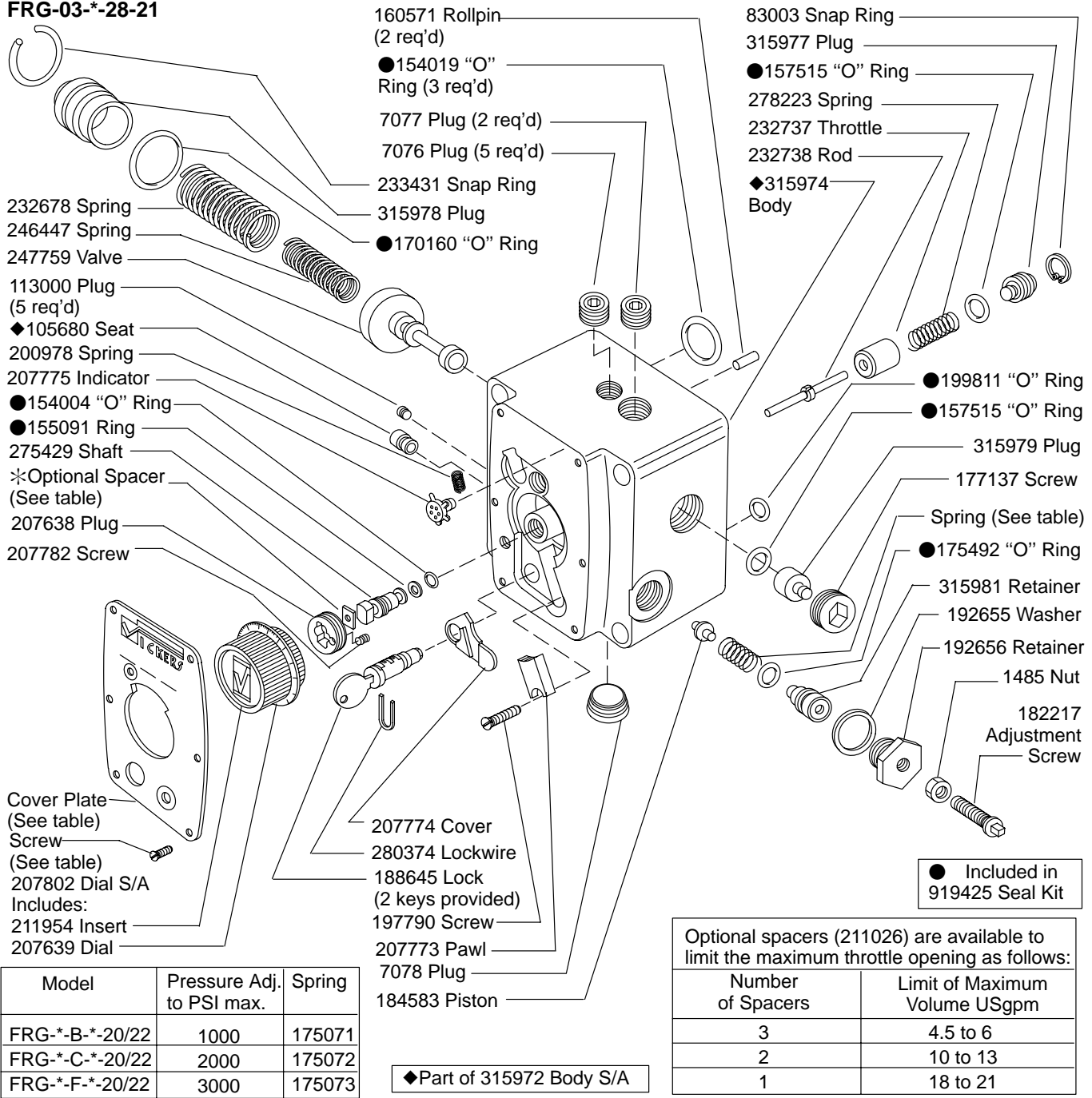

**Model Code**

**FRG - 03 - \* - 28 - 2\***

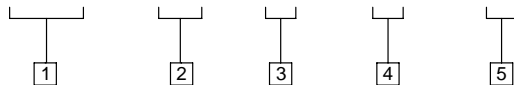

**1 Model Series**

**FRG** - Flow control, relief valve, gasket mounted

**3 Maximum Adjustable Pressure**

**B** - 1000 psi  
**C** - 2000 psi  
**F** - 3000 psi

**4 Maximum Capacity**

**28 USgpm**

**2 Series**

**03**

**5 Design**

For satisfactory service life of these components, use full flow filtration to provide fluid which meets ISO cleanliness code 18/15 or cleaner. Selections from Eaton OFF, OFR and OFRS filter series are recommended.

Printed in U.S.A.