

Relief Valves

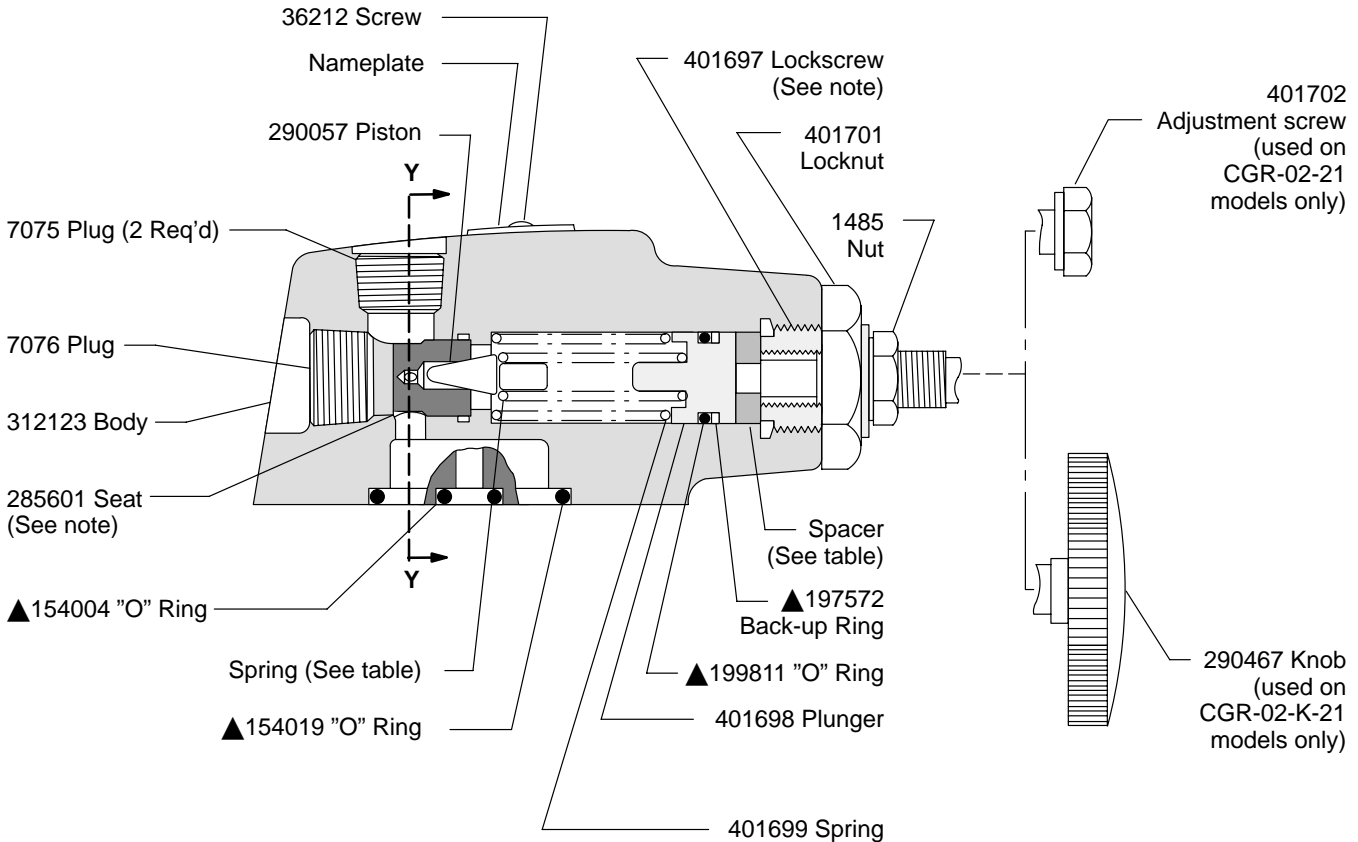

Remote Control Relief Valve

CGR-02-*-**(K)**-21



| STD/F3 Seal Kit Cross Reference | |
|---------------------------------|-----------|
| ▲ STD 919853 | F3 919854 |
| 154004 | 262330 |
| 154019 | 262394 |
| 197572 | 197572 |
| 199811 | 262334 |

NOTE: Assemble lockscrew with stepped outside diameter end toward spacer.

NOTE: Assemble 285601 seat with cross hole in position shown or 180° from position shown.

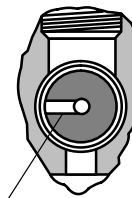

Y-Y

| Model | Max. Adj. Pressure | Spring | Spacer |
|-----------------|--------------------|--------|--------|
| CGR-02-B-(K)-21 | 1000 PSI | 2280 | — |
| CGR-02-C-(K)-21 | 2000 PSI | 583937 | — |
| CGR-02-F-(K)-21 | 3000 PSI | 401700 | 386715 |



Model Code

CG **R** - **02** - ***** - **(K)** - **21**

┌───┐ ┌───┐ ┌───┐ ┌───┐ ┌───┐ ┌───┐
| | | | | | | | | | | |
└───┘ └───┘ └───┘ └───┘ └───┘ └───┘
1 2 3 4 5 6

1 Model Series

CG - 0-3000 PSI Gasket mounted relief valve

2 Type

Remote control

3 Size

1/4 inch

4 Maximum Adjustment Pressure

B - 1000 PSI
C - 2000 PSI
F - 3000 PSI

6 Design

5 Knob

K - Optional
Omit for hex head adjustment screw

For satisfactory service life of these components, use full flow filtration to provide fluid which meets ISO cleanliness code 20/18/15 or cleaner. Selections from Eaton OFP, OFR and OFRS filter series are recommended.

Printed in U.S.A.