

Hose End 757 'E' Series

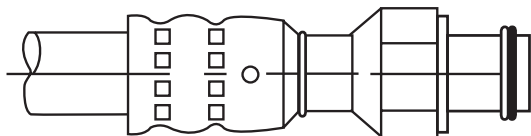

Refer to pages 31-66 or the Weatherhead Hose End and Tool Selector Chart for Qualified Sizes.

⚠ Refer to important safety information on page 3.

757 'E' Series Air Conditioning Procedure

The Coll-O-Crimp® system can be used to make original equipment assemblies using factory replacement ends as listed on pages 139-146. If the required hose end is not found, our **Flareless** hose end can be used. By following the instructions on this page, a new hose assembly can be made by combining Weatherhead's hose end with the original equipment end configuration.

- Typical original equipment assembly.
- Typical assembly of a Flareless hose end used with an old original equipment end configuration.
- Weatherhead replacement assemblies using original equipment tubing with Weatherhead 757 'E' Series hose ends.

Preparation - Flareless Tube Assembly

1. Remove the bad tube assembly or if room permits, perform the cutting procedure in place. Cut the tube squarely and as close to the hose connection as possible. Allow an adequate straight area for the flareless nut and sleeve to move freely for installation purposes. Deburr the inside and outside diameters of the tubing.

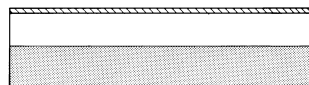

Make Presetting Operation

1. Slide nut and then sleeve onto tube. Shoulder of sleeve must be toward nut.
2. Lubricate threads, seat in hose end and flareless sleeve with a good grade of lubricant. Insert tube into seat of hose end, making sure that tube is bottomed, **TIGHTEN HAND TIGHT** and then tighten an **ADDITIONAL 1 to 1-1/6 turns** with a wrench.

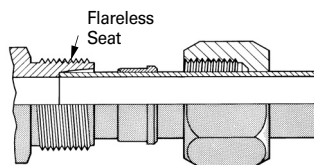
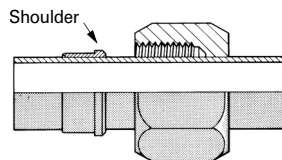

Note: Compensate for tubing being removed by adding to the over all length of the replacement hose assembly.

Typical Applications: Used with R134a and R12 applications. Ideal for heavy duty truck use as well as industrial and automotive applications.

Compatible Hose: H429; H757

Pressure: Determined by hose burst pressure. See page 14 for working pressure ratings for hose end configurations.

Material: Carbon steel

Plating: Black; zinc with rust preventive.

Advantages: Wide selection of hose ends which include the flareless ends, allowing use of existing tubing. Steel hose ends handle heavy duty demands.

Assemble With: T-400-1, T-410-1, T-420-1, T-440-1, T-460, T-462, T-465-1, T-475-1, T-480.

Ordering Information: Order individually by catalog number.

Note: Refer to current price list for availability of cataloged items. Configurations and dimensions subject to change without notice.

Label Set: FS-3200

†To determine the correct length of hose, subtract the cut-off factor for each end fitting from the overall length of assembly. All dimensions shown in inches.

Bumped Tube O-Ring Male Rigid

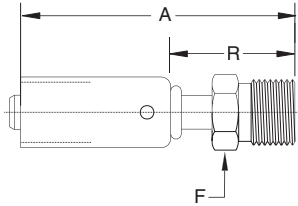

HOSE I.D.	TUBE SIZE	CATALOG NUMBER	THREAD SIZE	LENGTH A	RUN R	HOSE CUT-OFF FACTOR†	HEX F
5/16	3/8	75706E-W06	5/8-18	2.94	1.54	1.63	5/8
13/32	1/2	75708E-W08	3/4-16	3.26	1.86	2.00	3/4
1/2	5/8	75710E-W10	7/8-14	3.35	1.95	2.13	7/8
5/8	5/8	75712E-W10	7/8-14	3.56	2.06	2.25	7/8
5/8	3/4	75712E-W12	1-1/16-14	3.56	2.06	2.25	1-1/16

Bumped Tube O-Ring Male Swivel

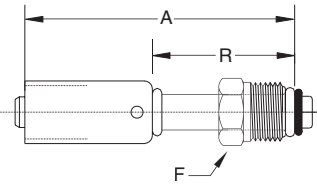

HOSE I.D.	TUBE SIZE	CATALOG NUMBER	THREAD SIZE	LENGTH A	RUN R	HOSE CUT-OFF FACTOR†	HEX F	O-RING
5/16	3/8	75706E-Z06	5/8-18	2.94	1.54	1.63	5/8	ZW74706
5/16	1/2	75706E-Z08	3/4-18	3.15	1.75	1.88	3/4	ZW74708
13/32	1/2	75708E-Z08	3/4-18	3.26	1.86	2.00	3/4	ZW74708
1/2	5/8	75710E-Z10	7/8-18	3.35	1.95	2.13	7/8	ZW74710
1/2	3/4	75710E-Z12	1-1/16-16	3.46	2.06	2.25	1-1/16	ZW74712
5/8	5/8	75712E-Z10	7/8-18	3.56	2.06	2.25	7/8	ZW74710
5/8	3/4	75712E-Z12	1-1/16-16	3.56	2.06	2.25	1-1/16	ZW74712

(Includes O-Ring)

Flareless Tube Rigid (With Nut and Sleeve)

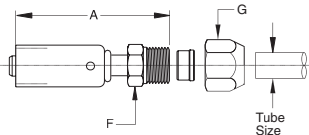

HOSE I.D.	TUBE SIZE	CATALOG NUMBER	THREAD SIZE	LENGTH A	HOSE CUT-OFF FACTOR†	HEX F	HEX G
5/16	3/8	75706E-756	5/8-18	2.59	1.38	5/8	3/4
5/16	1/2	75706E-758	3/4-16	2.71	1.50	3/4	7/8
13/32	3/8	75708E-756	5/8-18	2.65	1.38	5/8	3/4
13/32	1/2	75708E-758	3/4-16	2.78	1.50	3/4	7/8
13/32	5/8	75708E-760	7/8-14	2.90	1.63	7/8	1-1/16
1/2	1/2	75710E-758	3/4-16	2.84	1.63	3/4	7/8
1/2	5/8	75710E-760	7/8-14	2.90	1.63	7/8	1-1/16
5/8	5/8	75712E-760	7/8-14	3.13	1.75	7/8	1-1/16
5/8	3/4	75712E-762	1-1/16-14	3.25	1.88	1-1/16	1-1/4

SAE 45° Male Rigid

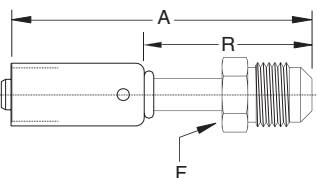

HOSE I.D.	TUBE SIZE	CATALOG NUMBER	THREAD SIZE	LENGTH A	RUN R	HOSE CUT-OFF FACTOR†	HEX F
5/16	3/8	75706E-306	5/8-18	3.28	1.88	2.00	5/8
13/32	1/2	75708E-308	3/4-16	3.40	2.00	2.13	3/4
1/2	5/8	75710E-310	7/8-14	3.71	2.31	2.50	7/8
5/8	3/4	75712E-312	1-1/16-14	4.00	2.50	2.75	1-1/16

†To determine the correct length of hose, subtract the cut-off factor for each end fitting from the overall length of assembly. All dimensions shown in inches.

*High Side Port
**Low Side Port

Bumped Tube O-Ring Female Swivel

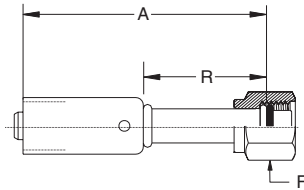

HOSE I.D.	TUBE SIZE	CATALOG NUMBER	THREAD SIZE	LENGTH A	RUN R	HOSE CUT-OFF FACTOR†	HEX F	O-RING
5/16	3/8	75706E-Z47	5/8-18	2.78	1.38	1.50	3/4	ZW74706
5/16	1/2	75706E-Z49	3/4-16	2.90	1.50	1.63	7/8	ZW74708
13/32	1/2	75708E-Z49	3/4-16	3.06	1.66	1.75	7/8	ZW74708
13/32	5/8	75708E-Z51	7/8-14	3.09	1.69	1.88	1-1/16	ZW74710
1/2	5/8	75710E-Z51	7/8-14	3.09	1.69	1.88	1-1/16	ZW74710
1/2	3/4	75710E-Z53	1-1/16-14	3.21	1.81	2.00	1-1/4	ZW74712
5/8	5/8	75712E-Z51	7/8-14	3.31	1.81	2.00	1-1/16	ZW74710
5/8	3/4	75712E-Z53	1-1/16-14	3.31	1.81	2.00	1-1/4	ZW74712

(Includes O-Ring)

Bumped Tube O-Ring Female Swivel W/R134a Service Port

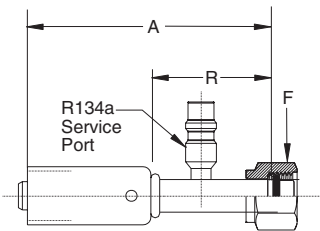

HOSE I.D.	TUBE SIZE	CATALOG NUMBER	THREAD SIZE	LENGTH A	RUN R	HOSE CUT-OFF FACTOR†	HEX F	O-RING
5/16	3/8	75706E-Z57*	5/8-18	4.28	1.88	3.00	3/4	ZW74706
13/32	1/2	75708E-Z59*	3/4-16	4.28	1.88	3.00	7/8	ZW74708
1/2	5/8	75710E-Z61**	7/8-14	4.52	2.12	3.25	1-1/16	ZW74710
5/8	5/8	75712E-Z61**	7/8-14	4.62	3.05	3.25	1-1/16	ZW74710

SAE 45° Flare Female Swivel

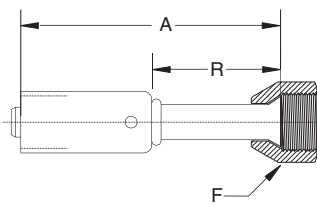

HOSE I.D.	TUBE SIZE	CATALOG NUMBER	THREAD SIZE	LENGTH A	RUN R	HOSE CUT-OFF FACTOR†	HEX F
5/16	3/8	75706E-406	5/8-18	2.78	1.38	1.50	3/4
5/16	1/2	75706E-408	3/4-16	2.90	1.50	1.75	7/8
13/32	1/2	75708E-408	3/4-16	2.84	1.44	1.56	7/8
1/2	5/8	75710E-410	7/8-14	3.09	1.69	1.81	1-1/16
5/8	5/8	75712E-410	7/8-14	3.25	1.75	2.00	1-1/16
5/8	3/4	75712E-412	1-1/16-14	3.25	1.75	2.00	1-1/4

Hose Splicer

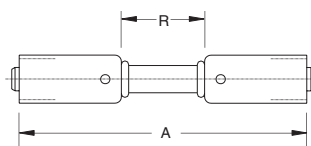

HOSE I.D.	HOSE I.D.	CATALOG NUMBER	LENGTH A	RUN R	HOSE CUT-OFF FACTOR†
5/16	5/16	75706E-Y36	4.30	1.50	1.50
5/16	13/32	75706E-Y38	4.30	1.50	1.50
13/32	13/32	75708E-Y38	4.30	1.50	1.50
13/32	1/2	75708E-Y40	4.43	1.63	1.63
1/2	1/2	75710E-Y40	4.43	1.63	1.63
1/2	5/8	75710E-Y41	4.65	1.75	1.75
5/8	5/8	75712E-Y41	4.75	1.75	1.75

For crimping information see page 323-328.

†To determine the correct length of hose, subtract the cut-off factor for each end fitting from the overall length of the assembly. All dimensions shown in inches.

Hose Splicer W/R134a Service Port

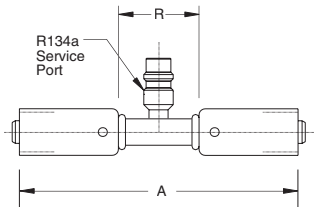

HOSE I.D.	HOSE I.D.	CATALOG NUMBER	LENGTH A	RUN A	HOSE CUT-OFF FACTOR†
5/16	5/16	75706E-Y47*	5.42	2.62	1.50
13/32	13/32	75708E-Y48*	5.42	2.62	1.50
1/2	1/2	75710E-Y49**	5.42	2.62	1.63
5/8	5/8	75712E-Y50**	5.62	2.62	1.75

For crimping information see page 328)

SAE 45° Flare Male Rigid 45° Tube Elbow

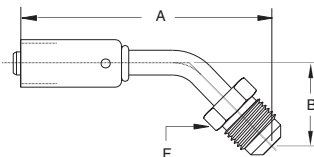

HOSE I.D.	TUBE SIZE	CATALOG NUMBER	THREAD SIZE	LENGTH A	DROP B	HOSE CUT-OFF FACTOR†	HEX F
13/32	1/2	75708E-388	3/4-16	3.65	1.25	2.50	3/4
1/2	5/8	75710E-390	7/8-14	4.21	1.56	3.00	7/8

Bumped Tube O-Ring Male Swivel 45° Tube Elbow

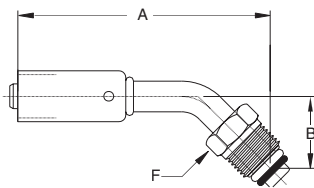

HOSE I.D.	TUBE SIZE	CATALOG NUMBER	THREAD SIZE	LENGTH A	DROP B	HOSE CUT-OFF FACTOR†	HEX F	O-RING
5/16	3/8	75706E-Z26	5/8-18	3.09	.88	1.88	5/8	ZW74706
13/32	1/2	75708E-Z28	3/4-18	3.59	1.03	2.38	3/4	ZW74708
1/2	5/8	75710E-Z30	7/8-18	3.71	1.06	2.50	7/8	ZW74710
5/8	5/8	75712E-Z30	7/8-18	4.19	1.19	2.88	7/8	ZW74710
5/8	3/4	75712E-Z32	1-1/16-16	4.19	1.19	2.88	1-1/16	ZW74712

(Includes O-Ring)

Bumped Tube O-Ring Female Swivel 45° Tube Elbow

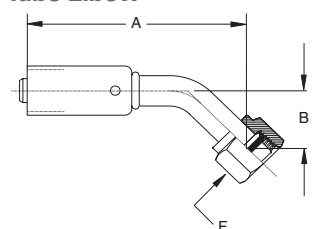

HOSE I.D.	TUBE SIZE	CATALOG NUMBER	THREAD SIZE	LENGTH A	DROP B	HOSE CUT-OFF FACTOR†	HEX F	O-RING
5/16	3/8	75706E-W47	5/8-18	3.51	.68	2.25	3/4	ZW74706
13/32	1/2	75708E-W49	3/4-16	3.63	1.05	2.25	7/8	ZW74708
1/2	5/8	75710E-W51	7/8-14	3.65	1.19	2.50	1-1/16	ZW74710
5/8	5/8	75712E-W51	7/8-14	4.00	1.29	2.75	1-1/16	ZW74710
5/8	3/4	75712E-W53	1-1/16-14	3.84	.94	2.50	1-1/4	ZW74712

(Includes O-Ring)

† To determine the correct length of hose, subtract the cut-off factor for each end fitting from the overall length of the assembly. All dimensions shown in inches.

SAE 45° Flare Female Swivel 45° Tube Elbow

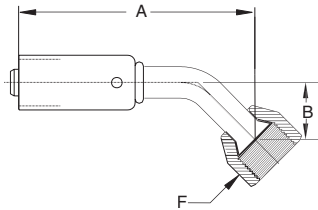

HOSE I.D.	TUBE SIZE	CATALOG NUMBER	THREAD SIZE	LENGTH A	DROP B	HOSE CUT-OFF FACTOR†	HEX F
5/16	3/8	75706E-486	5/8-18	3.42	.55	2.00	3/4
13/32	1/2	75708E-488	3/4-16	3.72	.58	2.50	7/8
1/2	5/8	75710E-490	7/8-14	4.34	.72	3.00	1-1/16
5/8	5/8	75712E-490	7/8-14	5.00	1.00	3.50	1-1/16
5/8	3/4	75712E-492	1-1/16-14	4.44	.72	3.00	1-1/4

SAE 45° Male Rigid 90° Elbow

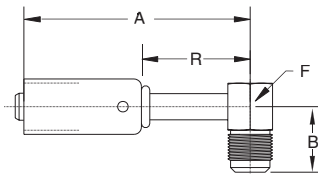

HOSE I.D.	TUBE SIZE	CATALOG NUMBER	THREAD SIZE	LENGTH A	RUN R	DROP B	HOSE CUT-OFF FACTOR†	HEX/SQUARE F
5/16	3/8	75706E-X06	5/8-18	4.07	2.67	.91	3.00	5/8
13/32	1/2	75708E-X08	3/4-16	4.14	2.74	1.47	3.00	7/8
1/2	5/8	75710E-X10	7/8-14	4.25	2.85	1.47	3.00	7/8
5/8	3/4	75712E-X12	1-1/16-14	4.45	2.95	1.56	3.00	1-1/16

Bumped Tube O-Ring Male Rigid 90° Tube Elbow

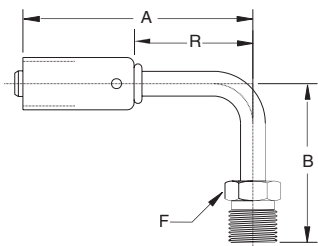

HOSE I.D.	TUBE SIZE	CATALOG NUMBER	THREAD SIZE	LENGTH A	RUN R	DROP B	HOSE CUT-OFF FACTOR†	HEX F
5/16	3/8	75706E-W66	5/8-18	4.00	2.60	1.53	2.75	5/8
13/32	1/2	75708E-W68	3/4-16	4.07	2.67	2.12	2.75	3/4
1/2	5/8	75710E-W70	7/8-14	4.15	2.75	2.21	2.88	7/8

Bumped Tube O-Ring Male Swivel 90° Tube Elbow

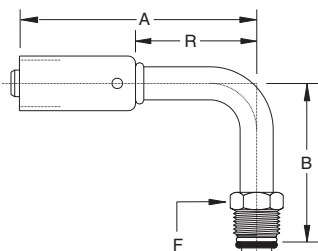

HOSE I.D.	TUBE SIZE	CATALOG NUMBER	THREAD SIZE	LENGTH A	RUN R	DROP B	HOSE CUT-OFF FACTOR†	HEX F	O-RING
5/16	3/8	75706E-Z66	5/8-18	4.00	2.60	1.53	2.75	5/8	ZW74706
5/16	1/2	75706E-Z68	3/4-18	4.07	2.67	1.53	2.75	3/4	ZW74708
13/32	3/8	75708E-Z66	5/8-18	4.00	2.60	1.77	2.75	5/8	ZW74706
13/32	1/2	75708E-Z68	3/4-18	4.07	2.67	2.12	2.75	3/4	ZW74708
1/2	5/8	75710E-Z70	7/8-18	4.15	2.75	2.21	2.88	7/8	ZW74710
1/2	3/4	75710E-Z72	1-1/16-16	4.25	2.85	2.35	3.00	1-1/16	ZW74712
5/8	5/8	75712E-Z70	7/8-18	4.24	2.74	2.25	2.88	7/8	ZW74710
5/8	3/4	75712E-Z72	1-1/16-16	4.35	2.85	2.87	3.00	1-1/16	ZW74712

(Includes O-Ring)

† To determine the correct length of hose, subtract the cut-off factor for each end fitting from the overall length of the assembly. All dimensions shown in inches.

*High Side Port
**Low Side Port
¹Has body machined from hexstock.

Bumped Tube O-Ring Female Swivel 90° Tube Elbow

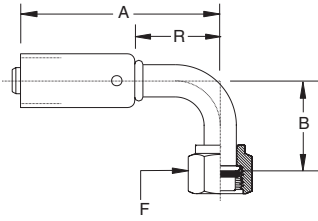

HOSE I.D.	TUBE SIZE	CATALOG NUMBER	THREAD SIZE	LENGTH A	RUN R	DROP B	HOSE CUT-OFF FACTOR†	HEX F	O-RING
5/16	3/8	75706E-Z87	5/8-18	4.07	2.67	1.12	2.75	3/4	ZW74706
5/16	1/2	75706E-Z89	3/4-16	4.14	2.74	1.31	2.88	7/8	ZW74708
13/32	3/8	75708E-Z87	5/8-18	4.07	2.67	1.31	2.75	3/4	ZW74706
13/32	1/2	75708E-Z89	3/4-16	4.14	2.74	1.50	2.88	7/8	ZW74708
1/2	5/8	75710E-Z91	7/8-14	4.25	2.85	1.75	3.00	1-1/16	ZW74710
5/8	5/8	75712E-Z91	7/8-14	4.35	2.85	1.75	3.00	1-1/16	ZW74710
5/8	3/4	75712E-Z93	1-1/16-14	4.45	2.95	1.75	3.13	1-1/4	ZW74712

(Includes O-Ring)

Bumped Tube O-Ring Female Swivel 90° Tube Elbow W/R134a Service Port

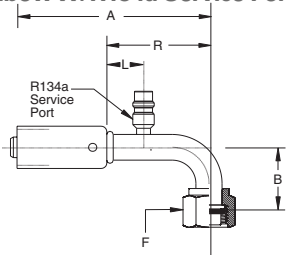

HOSE I.D.	TUBE SIZE	CATALOG NUMBER	A	THREAD SIZE	RUN R	DROP B	HOSE CUT-OFF FACTOR†	HEX F	LENGTH L	O-RING
5/16	3/8	75706E-Z97*	2.52	5/8-18	2.12	1.12	2.75	3/4	1.50	ZW74706
13/32	1/2	75708E-Z99*	4.15	3/4-16	2.75	1.68	2.88	7/8	1.50	ZW74708
1/2	5/8	75710E-Z01**	3.78	7/8-14	2.38	1.50	3.00	1-1/16	1.50	ZW74710
5/8	5/8	75712E-Z01**	4.61	7/8-14	3.11	1.95	3.00	1-1/16	1.50	ZW74710

(Includes O-Ring)

For crimping information see page 328.

SAE 45° Flare Female Swivel 90° Tube Elbow

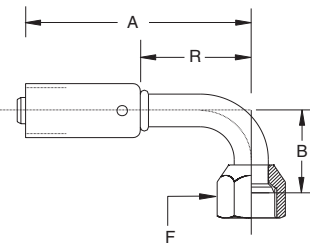

HOSE I.D.	TUBE SIZE	CATALOG NUMBER	A	THREAD SIZE	RUN R	DROP B	HOSE CUT-OFF FACTOR†	HEX F
5/16	3/8	75706E-466	4.07	5/8-18	2.67	1.12	2.75	3/4
13/32	1/2	75708E-468	4.14	3/4-16	2.74	1.31	2.88	7/8
1/2	5/8	75710E-470	4.25	7/8-14	2.85	1.56	3.00	1-1/16
5/8	5/8	75712E-470	4.35	7/8-14	2.85	1.50	3.00	1-1/16
5/8	3/4	75712E-472	4.45	1-1/16-14	2.95	1.75	3.13	1-1/4

Bumped Tube O-Ring Service Port Adapter W/R134a Service Port

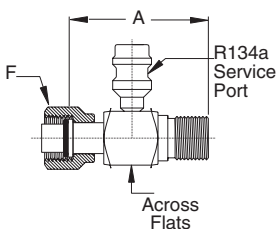

TUBE SIZE	CATALOG NUMBER	THREAD SIZE	LENGTH A	ACROSS FLATS	HEX F	O-RING
3/8	75701*	5/8-18	2.02	5/8 ¹	3/4	ZW74706
1/2	75702*	3/4-16	2.22	7/8	7/8	ZW74708
5/8	75704**	7/8-14	2.63	7/8	1-1/16	ZW74710
3/4	75706**	1-1/16-14	2.89	1-1/16	1-1/4	ZW74712

(Includes O-Ring)

† To determine the correct length of hose, subtract the cut-off factor for each end fitting from the overall length of the assembly. All dimensions shown in inches.

*High Side Port
**Low Side Port

¹Has body machined from hex stock.

Bumped Tube O-Ring Service Port Adapter W/R12 Service Port

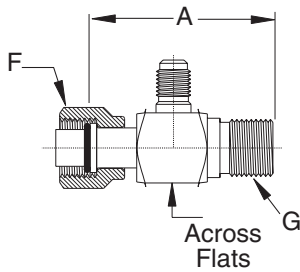

TUBE SIZE	CATALOG NUMBER	THREAD SIZE G	LENGTH A	ACROSS FLATS	HEX F	SERVICE PORT THREAD	O-RING
3/8	R12-Z56*	5/8-18	2.02	5/8 ¹	3/4	3/8-24	ZW74706
1/2	R12-Z58*	3/4-16	2.22	7/8	7/8	3/8-24	ZW74708
5/8	R12-Z60**	7/8-14	2.63	7/8	1-1/16	3/8-24	ZW74710
3/4	R12-Z62**	1-1/16-14	2.89	1-1/16	1-1/4	7/16-20	ZW74712

(Includes O-Ring)

90° Bumped Tube O-Ring R134a Service Port Adapter

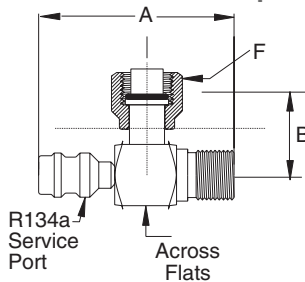

TUBE SIZE	CATALOG NUMBER	THREAD SIZE	LENGTH A	DROP B	ACROSS FLATS	HEX F	O-RING
3/8	75729*	5/8-18	2.40	1.05	5/8 ¹	3/4	ZW74706
1/2	75730*	3/4-16	2.60	1.15	7/8	7/8	ZW74708
5/8	75731**	7/8-14	2.74	1.30	7/8	1-1/16	ZW74710
3/4	75732**	1-1/16-14	3.10	1.39	1-1/16 ¹	1-1/4	ZW74712

(Includes O-Ring)

90° Bumped Tube O-Ring R12 Service Port Adapter

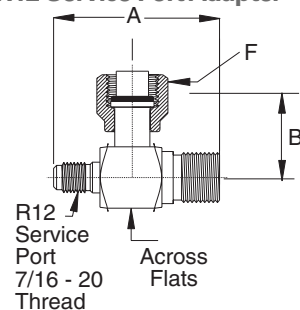

TUBE SIZE	CATALOG NUMBER	THREAD SIZE	LENGTH A	DROP B	ACROSS FLATS	HEX F	O-RING
3/8	R12-Z96*	5/8-18	2.07	1.05	5/8 ¹	3/4	ZW74706
1/2	R12-Z97*	3/4-16	2.27	1.15	7/8	7/8	ZW74708
5/8	R12-Z98**	7/8-14	2.41	1.30	7/8	1-1/16	ZW74710
3/4	R12-Z99**	1-1/16-16	2.77	1.39	1-1/16 ¹	1-1/4	ZW74712

(Includes O-Ring)

Note: 3/8-24 Thread (High Side Port)
7/16-20 Thread (Low Side Port)

Replacement O-Rings

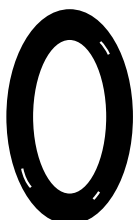

TUBE O.D.	CATALOG NUMBER
3/8	ZW74706
1/2	ZW74708
5/8	ZW74710
3/4	ZW74712

Material: Hydrogenated Nitrile (HNBR), 70 Durometer
Temperature Range: -40°F to +250°F (-40°C to +121°C)
Color: Green

**Tube-O to Male Bumped
Tube O-Ring 90° Elbow
with R134a Service**

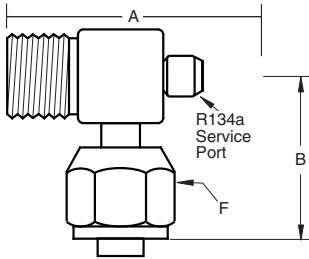

TUBE SIZE	CATALOG NUMBER	LENGTH A	DROP B	TUBE-O THREAD
1/2	75750	2.64	1.15	3/4-16
5/8	75751	2.78	1.29	7/8-14

**Rotalok to Male Bumped
Tube O-Ring 90° Elbow
with R134a Service**

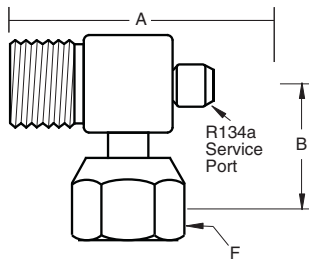

TUBE SIZE	CATALOG NUMBER	LENGTH A	DROP B	ROTALOK THREAD F
1/2	75760	2.64	1.15	1-14
5/8	75761	2.78	1.29	1-14

**Service Instructions for
Replacement of Damaged
O.E. Hose Assemblies**

Weatherhead service port adapters offer an alternative to the high cost of replacement and time out of service which can occur when an air conditioning assembly is damaged. By using the Weatherhead adapter, service personnel can remove the damaged end and replace it with a standard Weatherhead 757 'E' series hose end used in conjunction with a Weatherhead service port adapter. This is a welcome solution to get your customer back on the road without special orders and long delays.

